

**GENERAL NOTES:**

- JUNCTION BOX LOCATIONS AND CONDUIT ROUTING ARE SCHEMATIC. ALIGN JUNCTION BOXES WITH PAVEMENT EDGES. CONDUIT ROUTING SHALL AVOID TREES. SUBMIT CONDUIT AND JUNCTION BOX LAYOUT PLAN TO ENGINEER PRIOR TO INSTALLATION.
- MAINTAIN AND PROTECT ALL EXISTING UNDERGROUND UTILITIES. CONTRACTOR TO PROVIDE LOCATE PRIOR TO ANY EXCAVATION. PRIOR TO STARTING CONSTRUCTION, CONTRACTOR SHALL CALL 811 LOCATES FOR UTILITY LOCATIONS.
- ALL SPARE/EMPTY CONDUIT TO BE PROVIDED WITH NYLON PULL STRINGS.
- ALL JUNCTION BOXES AND CONDUITS ARE SHOWN IN APPROXIMATE LOCATIONS. VERIFY LOCATION OF PROPERTY LINE, EASEMENTS AND UTILITIES PRIOR TO PLACEMENT.
- ALL CONDUITS LENGTHS ARE APPROXIMATE.
- CAP ALL UNUSED CONDUITS. WHERE CONDUITS ARE CAPPED MARK LOCATION WITH AN ELECTRICAL MARKER.
- FIELD BENDING OF STRAIGHT CONDUIT SECTIONS INTO LONG RADIUS SWEEPS IS PREFERRED.
- GROUND ALL IN-GROUND JUNCTION BOXES, HAND HOLES, AND PULL BOXES PER MOST CURRENT VERSION OF THE NEC.

**FLAG NOTES:**

NOT USED.

**LEGEND:**

- FLOODLIGHT POLE
- △ FLOODLIGHT WITH GLARE CONTROL SHIELDING, 400 WATT LED, 4500K, 480 VOLT
- ▲ FLOODLIGHT WITH GLARE CONTROL SHIELDING, 600 WATT LED, 4500K, 480 VOLT
- ▴ FLOODLIGHT WITH GLARE CONTROL SHIELDING, 900 WATT LED, 4500K, 480 VOLT
- ⬠ SHIELDED LED BALL TRACKING LIGHT, 575 WATT, 4500K, 480 VOLT
- AREA LUMINAIRE, 100 WATT LED, 480 VOLT, FULL CUTOFF

**POLE AND FLOODLIGHT SCHEDULE**

POLE	HEIGHT	FLOODLIGHTS	BT LIGHTS	AREA LIGHTS
S1	70'	7	1	0
S2	70'	7	1	0
S3	70'	7	1	1
S4	70'	7	1	1
		28	4	2

Revision	By	Appd	YYYY.MM.DD

File Name:	AAU Dwn.	JW Dgri.	CBF Chkd.

Permit/Seal



Client/Project Logo



Client/Project  
SEATTLE PUBLIC SCHOOLS

VAN ASSELT ELEMENTARY SCHOOL  
ATHLETIC FIELD RENOVATION  
SEATTLE, WA

Title  
ELECTRICAL SITE PLAN

Project No.  
204822133

Scale  
AS NOTED

Revision Sheet  
2 of 5

Drawing No.  
**E1.1**

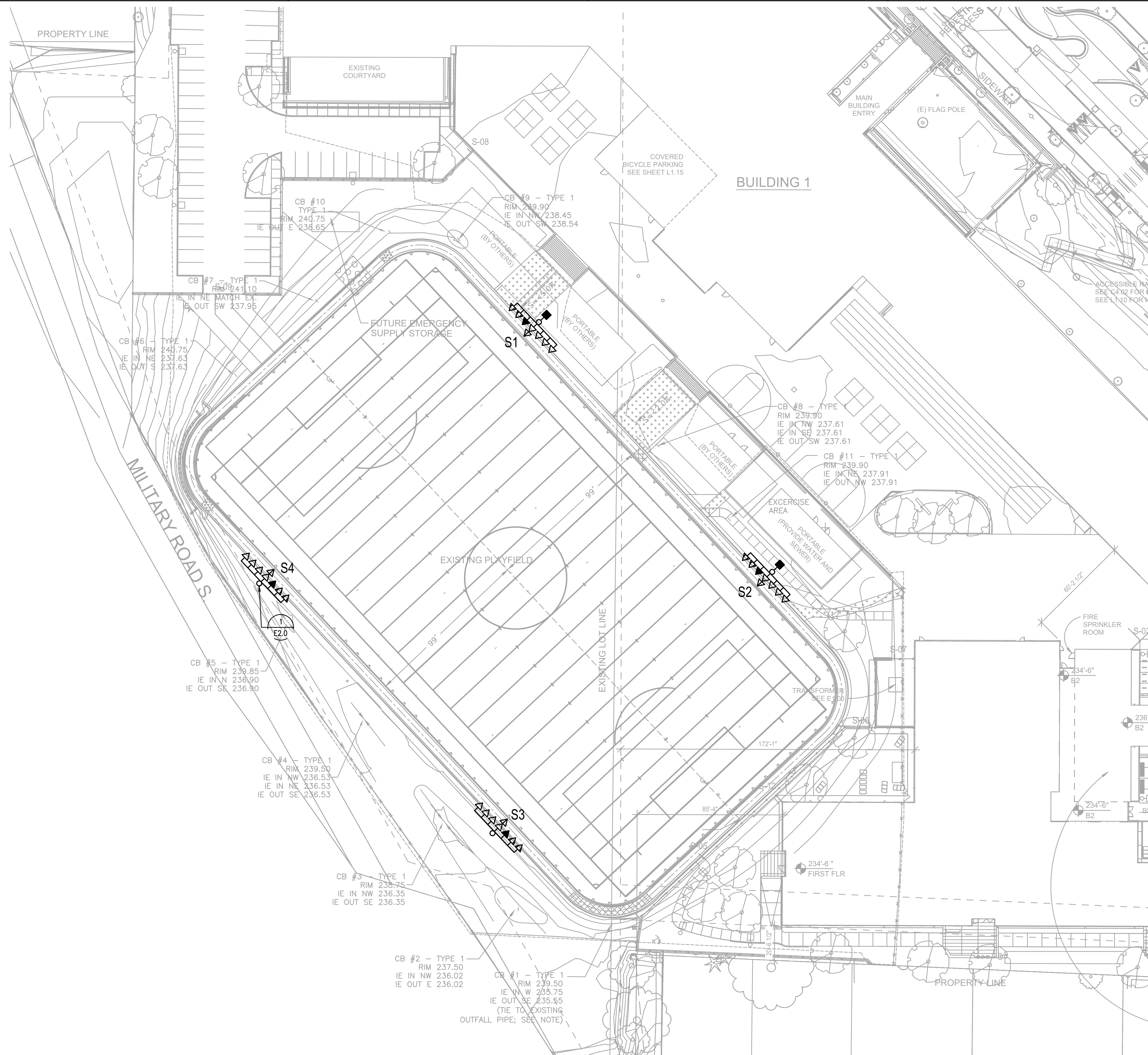

**ELECTRICAL SITE PLAN**  
SCALE: AS INDICATED

