

# MERCER INTERNATIONAL MIDDLE SCHOOL /

## SCHOOL DESIGN ADVISORY TEAM MEETING #2

# AGENDA

- + Welcome and SDAT #1 Recap
- + Photo Safari Review
- + District Wide Improvement Plan & Priorities (Strategic Plan)
- + School Improvement Plan and Priorities
- + Next Steps and Followup Questions





## SEATTLE PUBLIC SCHOOLS

- + Sarah Pritchett, Executive Director of Schools
- + Vince Gonzales, Senior Project Manager
- + Deborah Northern, Equity and Engagement Manger

## SHIELS OBLETZ JOHNSEN - Project Management

- + Brad Tong, Principal in Charge
- + Justine Kim, Senior Project Manager
- + Paige McGehee, Program Coordinator
- + Cheri Hendricks, Educational Planner
- + Jerome Hunter, Seattle School for Boys Founder

## BASSETTI ARCHITECTS - Design Team Lead

- + Caroline Lemay, Principal in Charge
- + Michael Davis, Design Principal
- + Lorne McConachie, Educational Planner
- + Amanda (Clausen) Hoehn, Project Manager
- + Manika Bhagra, Project Architect
- + Edward Arreola, Project Designer





## MERCER INTERNATIONAL MIDDLE SCHOOL

- + Cindy Watters, Principal
- + Sherri Encarnacion, Assistant Principal
- + Katie Humphreys, Special Education Teacher
- + Aaron Hennings, Music Teacher
- + Sue Monroe, Librarian
- + Janet Bautista, 7th Grade Science and Stem Teacher
- + Emily Elasky, 8th Grade Science and Stem Teacher
- + Matt Kochevar, Teacher
- + Virginia Andrews, School Counselor
- + Katie Badillo Wright, Teacher
- + Tracy Kolner, Attendance Specialist
- + Rumi Takahashi, Parent
- + Erin Okuno, Community member and future parent
- + Grace Floyd, Parent
- + Azi Brannock, Student
- + Logan Neil, Student



 DIVERSE 

 INCLUSIVE 

 ACCEPTING 

 WELCOMING 

 SAFE SPACE 

 FOR EVERYONE 

MERCER INT’L MIDDLE SCHOOL SDAT MEETING #1 / SPS STRATEGIC PLAN - FOCUS ON RACIAL EQUITY

Page 11

DN

Deborah Northern

# Seattle Public Schools: Focus on Racial Equity & Anti-Racism

START COURSE

DETAILS ▾

+ Seattle Public Schools: Focus on Racial Equity & Anti-Racism - Overview | Rise 360 (articulate.com)

Welcome to Seattle Public Schools! This is an opportunity to take a few minutes to learn more about our commitment to racial equity and anti racism reflected in the Seattle Excellence Strategic Plan.

MERCER INTERNATIONAL MIDDLE SCHOOL / 02.23.2021

bassetti architects

SOJ

SEATTLE PUBLIC SCHOOLS

- + SPS is committed to the success of each student. They want to **disrupt the legacies of systemic racism.**
- + Provide a **commitment to students of color furthest from educational justice**, starting with African American boys and young men.
- + Targeted universalism.
- + The practice of **identifying, challenging, and changing the values, structures, and behavior that perpetuate systemic racism.**
- + **SPS Priorities include:**
  1. High quality instruction and learning experiences
  2. Predictable and consistent operational systems
  - 3.Culturally responsive workforce
  - 4.Inclusive and authentic engagement



Centering the indigenous community and history. Making the outside and inside feel like it belongs to the communities of color. Outdoor space and grounding and how that is included in Middle School  
-Erin

Flexibility to change spaces in the future and capable to adapt to the technology. Would like this in classroom and community spaces. Having the outdoor space connect to the community.  
-Sue



A place where students have a voice, choice, and agency. They are valued members of our community and are heard. They can show how smart they are and showcase their passions.  
-Cindy

Community members (parents and friends) as well as students feel safe to congregate. A space that can be used by more than just students and staff, but also community people.  
-Janet (athletic coordinator)

Flexibility and future proofing so when educational styles, population, and technology change the building can evolve with all these changing circumstances. Does not want to see the site littered with portables in the future. Equity, inclusion for the whole community.  
-Rumi

Community is steeped in cultural wealth with linguistics. Would like to see spaces that are moveable and not permanent. Large groups and small groups to perform. Space to express themselves within the wealth of their community. Presentations, performance, etc.  
-Sherrie



- + Students have **voice, choice, and agency!**
- + Embracing the **community and creating a safe place** for them at the school.
- + **Flexibility** and future proofing
- + **Sustainable** materials
- + Need **more social hubs** for students to gather.
- + Honoring silence and **mindfulness** as well as **joyful noise**.
- + Opportunities for staff to connect.
- + **Places to perform** for students and community.
- + Helping communities of color see their **identity in the building**.





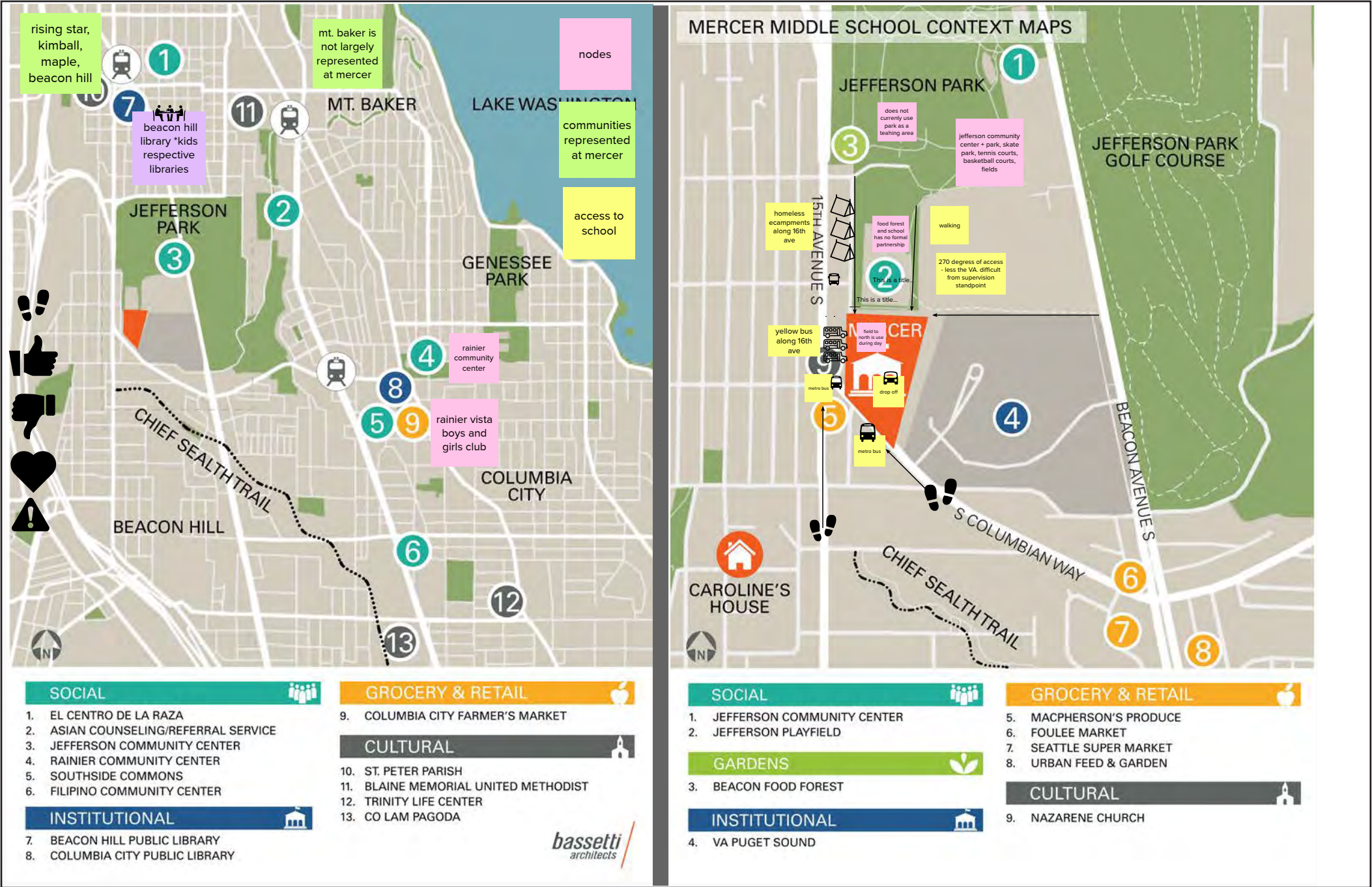

- + Students come to school from all directions
- + Students respect the local businesses
- + There are nearby partnerships (Food Forest, Alta Vista, Boys and Girls Club, etc.)
- + There are businesses that represent this community (The Station)
- + Traffic and student safety is a concern along 15th
- + Location for bus drop off is a concern with neighbors, homeless camp, and bus traffic
- + A lot of families have students at both Cleveland HS and Mercer MS





- + **Learn what spaces and places inspire**  
your fellow SDAT members from our photo safari.
- + **Highlight the District Strategic Plan**  
priorities most applicable to Mercer Int'l Middle School
- + Introduce the **Continuous School Improvement Plan (CSIP)** for Mercer

# PHOTO SAFARI REVIEW





Jefferson Park Community Center

The hub, safe haven, multi generational, multi cultural



Community Fridge

Proud of neighborhood / community. Speaks to the type of caring community



Mural

Murals give a Beacon Hill Feeling throughout the neighborhoods



Fou Lee Market and Deli

Stimulating interior, many languages, smell, multi lingual



Jefferson Park Clubhouse

Students gather, quiet space



Lawn Bowling

Community space at Jefferson Park, cultural activity





El Centro de la Raza

Courtyard named after founder, great community gathering space, food trucks, smaller spaces on the inside as well, plaza open 24/7, across from train, used for informal gatherings, been around since the 1970s



Langston Hughes Performing Arts

Community, culture, voice, performance



Kubota Garden

Near skyway, Japanese garden, beautiful for a stroll, place to gather, covered areas for groups, family take photos, free garden access to all

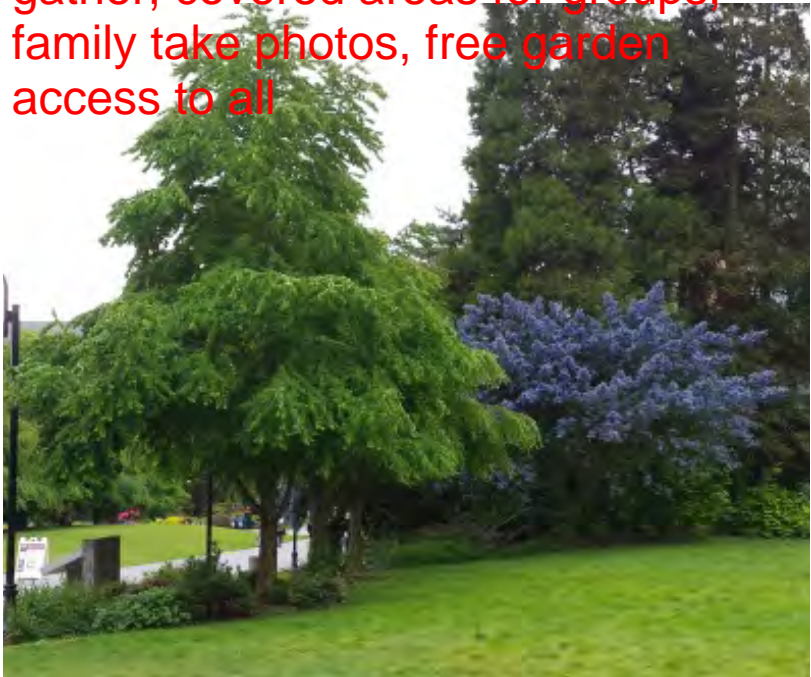

Seattle U Gardens

Gardens tucked throughout, lovely refuge in an urban center



Hing Hay Park

Activated the park, a place for activities like ping pong tournament, students frequent china town, a good hangout



El Quetzal Restaurant

Gathering, Staff at Mercer gather here, outdoor patio connection, owned by mercer family, lots of local shops





Beacon Hill Library

Landmark for community, smaller learning spaces



Asian Counseling and Referral Service (ACRS)

Flexible inside space, activated for senior lunches or other big gatherings, well known in asian american community as a go to place for meetings



Asian Counseling and Referral Service (ACRS)



Victrola Coffee Shop

Gathering place for students and community



The Station Coffee Shop

Gathering place for students and community. Same building as plaza, food pantries, giving PPE, strong community center



Jefferson Park (Samoan Cricket League)

Space used in a culturally specific way to anchor the community





African American Academy  
love design of building by well respected black architect, important to family life with african centered education



Chief Sealth Trail  
Trail is well loved



Kubota Gardens



The Station Coffee Shop



Beacon Hill Food Forest  
adjacent to the school, partnership with gardens, outdoor learning environment, connection to nature learn how food is grown, lifelong nutrition habits





Modern Learning Space

not square, open floor plan, not as regimented, moveable seating



Green Space

students want green space! and light. Places to sit outside, gardens



Green Space



Small Group Space

intimate and small space for smaller groups within a larger group area, seat 2-4



Library Space



Social Space with Greenery

students want green space! and light.





Modern Ancient Faith Church, Sacramento  
Windows, more light, greenery, brick, likes single level.



The Louvre View 2



Langley Meadows School, British Columbia



ASU Gammage Auditorium  
Circular, welcoming



Outdoor Seating



Summit Sierra School  
Open, flexible space, lots of windows, fun colors





Roslyn Park



Hamilton MS SpEd Kitchen



Chief Sealth SpEd Courtyard

Need a place to be a community, work together as a SpEd department, life skills space, multi classroom, community teaching, safe and contained courtyard



Courtyard



Orestad High School, Copenhagen



Outdoor classroom

covered, outdoors, teachers and students like outdoor opportunities, green and natural





A Building that Uses Solar Panels  
solar and sustainable



Library Space  
curves, low shelves for supervision



Green Space  
students want green space! and light.



Green Space



Modern Learning Space



Library Space  
Windows and light, capturing views, open





Modern Learning Space

Places for student "to just be" during social times. Sit and be social, multi use



Outdoor Play Areas



Indoor Green Space

students want green space! and light.



Green Space

students want green space! and light.



Indoor Green Space

students want green space! and light.



Places to Dine and Socialize





Stanford School of Design



University of Manitoba



Stanford School of Design

Nimbleness, display that is flexible, create space, invites innovation, industrialness, spaces are designed for thinking and learning, not predetermined, good light, large and small collaboration, forward thinking turn room into what it needs to be



Places to Dine and Socialize

students want green space! and light.



Flexible Learning Space



Saunalahti Communal Area



# DISTRICT-WIDE IMPROVEMENT PLAN & PRIORITIES (STRATEGIC PLAN)



- + Create **supportive and culturally responsive** environments.
- + Work in **partnership with families and communities** who represent students of color who are furthest from educational justice.
- + Students of color who are furthest from educational justice will feel **safe and welcome**
- + Students of color who are furthest from educational justice will be **proficient in mathematics in 7th grade**.





# Break Into Small Groups





# SCHOOL IMPROVEMENT PLAN & PRIORITIES





## EDUCATIONAL STRATEGIES

- + Literacy Workshop Model
- + Science and STEM program
- + Care for students **social-emotional life and learning life.**
- + **Outside of School** programming
- + Opportunities for **family engagement**
- + **Community Partnerships**







## POTENTIAL ARCHITECTURAL RESPONSES

- + **Flexible environments** that can support different types of learning
- + Student **collaboration, presentation, and performance space**
- + Enhanced opportunity for **student leadership and voice**
- + Integration of **community partnerships, family engagement and school community**
- + Opportunities for **innovation**
- + **Durability and longevity**

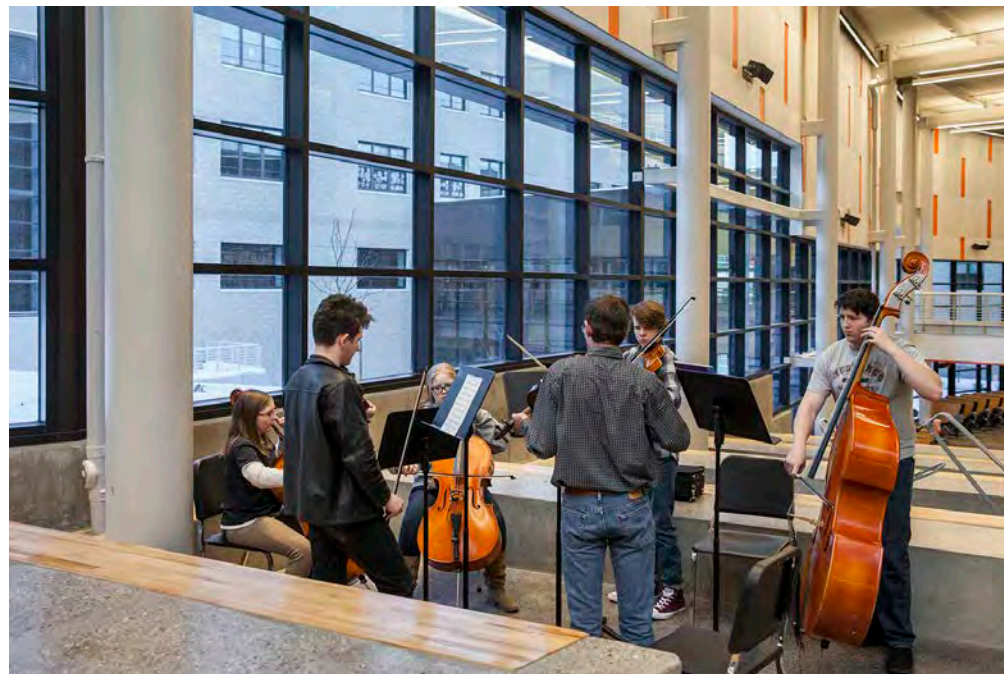





## What We Learned

- + We learned about space and places in the Mercer community that inspire and why.
- + We learned what people feel are powerful learning spaces or places and why.
- + We reviewed the foundation principles of the Strategic Plan and Racial Equity
- + We learned about the Continuous School Improvement Plan and how that can influence the spaces we create.





Next session

+ SDAT #3 will be April 6th from 6-7:30pm